

M.A.R  
A Visual discourse across space.

TECHNICAL DETAILS



**M.A.R is a complete and self-contained device that includes light and sound equipment in its structure, necessary for its performance in any space (scenic or non-conventional). In both cases, the audience and the performer are situated on the scene. The company provides all which is necessary for the performance including seats (unless the company is obliged to travel by plane, in which case they will have to be provided by the Festival).**

• MINIMUM STAGE MEASUREMENTS FOR A CAPACITY OF 40 PEOPLE

DEPTH: 6m  
WIDTH: 8m.

• MINIMUM STAGE MEASUREMENTS FOR A CAPACITY OF 60 PEOPLE

DEPTH: 8m.  
WIDTH: 10m.

- STAGE LIGHTING

**If the performance takes place in a non-conventional space:**

Stage Lightning: adjustable intensity if possible.  
1 power outlet on side angle of the scene.  
9/17 ROSCO stairs (1 x 2 m / 40 and 60 centimetres tall)

**If the performance takes place in a stage, the following elements will be required:**

- STAGE LIGHTING

Stage Lightning  
Power outlet on central batten for a lamp.  
Power outlet on side angle of the stage (next to Musician/Technician).  
Light board on side angle of the stage (next to Musician/Technician) or light technician helping with entry and exit lightening (stage lights are fully controlled by the company)  
10 PC 2KW  
8 REC.ETC 25/50 S4

- SOUND

Lapel or headband mic (1)  
DI (injection box) for instrument (1)  
PA team at the height of the public's ear, on stage

- STAGE MACHINERY

Possible setting of a lamp over table location, wired to Technician post.  
Platform or table to elevate musician, upon the event of live music.

- ESTIMATED TIME OF STAGING AND DISMANTLING

Estimated duration of staging: 4 hours.  
Estimated duration of dismantling: 1 hour and 30 minutes.

- OTHER REQUIREMENTS

**“Intimate” version for an audience of 40:**

17 chairs (preferably wooden, no armrests, under no circumstances).  
23 high stools in a 2nd row. Or 23 normal seats on three platforms (ROSCO stairs 1 x 2 m / 40 or 60 centimetres tall)

**Version for an audience of 60:**

40 chairs (preferably wooden, no armrests, under no circumstances).  
20 high stools in a 2nd row.  
10 ROSCO stairs (1 x 2 m / 60 centimetres tall)

4 benches or auxiliary tables to place props.

\* The company will provide 40 seats, unless it is necessary to travel by plane, in which case the hosting theatre will have to provide them or we will collectively think about the solution that best fits the particularities of the space.

\*If the company travel by aeroplane: 1 wood table (2,30 x 0,80 m)

\* During the performance a match is lit

- TECHNICAL STAFF FOR STAGING AND DISMANTLING

1 Support Technician for loading, lighting and machinery.

The company will require the technical rider of performance venue for prior arrangements (technical specifications and stage lighting plan), using any available material following the agreed conditions stipulated by the company's production department.

# PLAN OF THE STAGE SPACE

Stage version for a capacity of 40 seat:

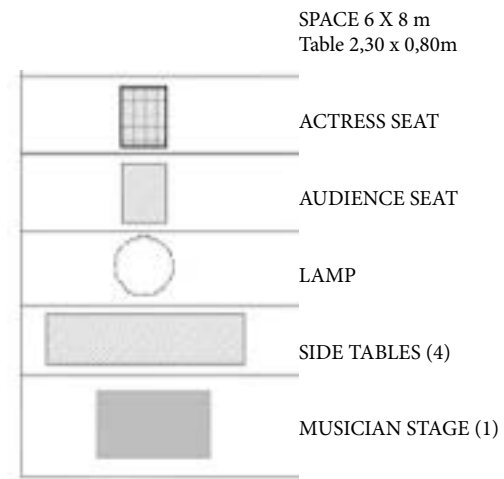
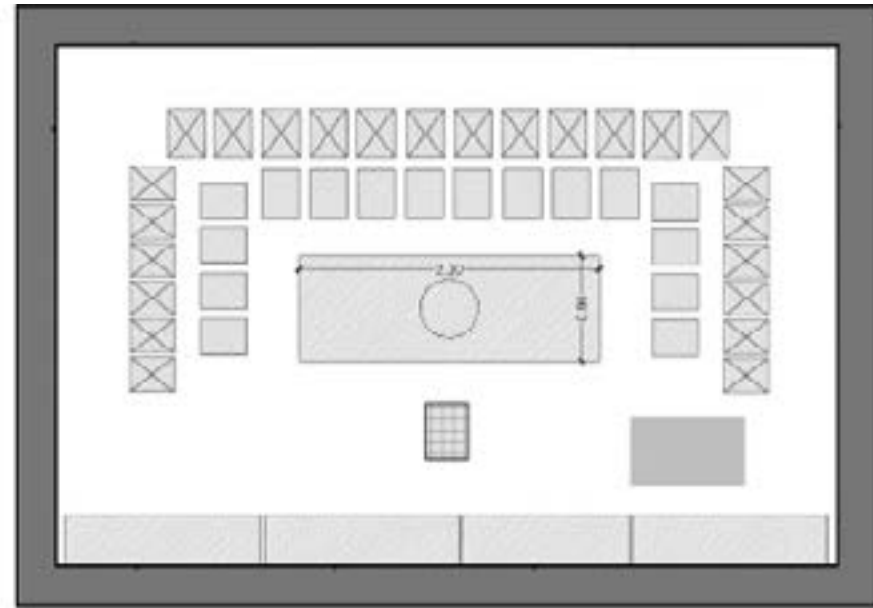

# LIGHTING PLAN / Non-conventional space

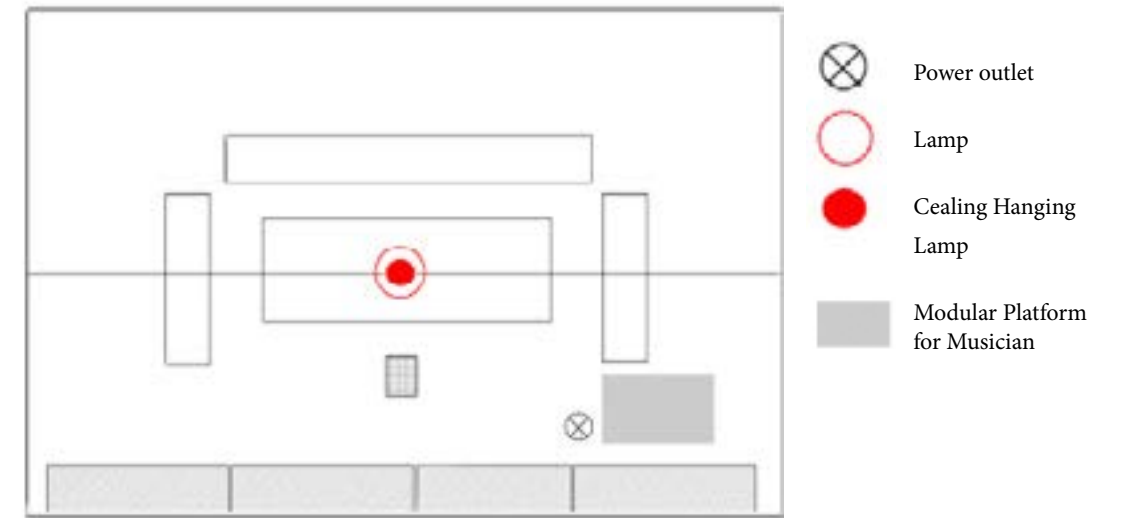

Stage version for a capacity of 60 seat:

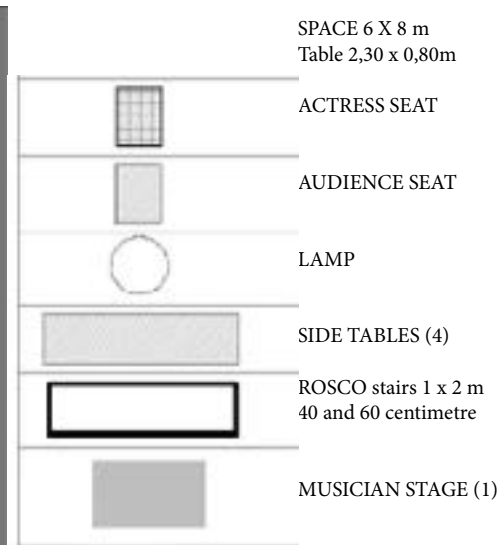
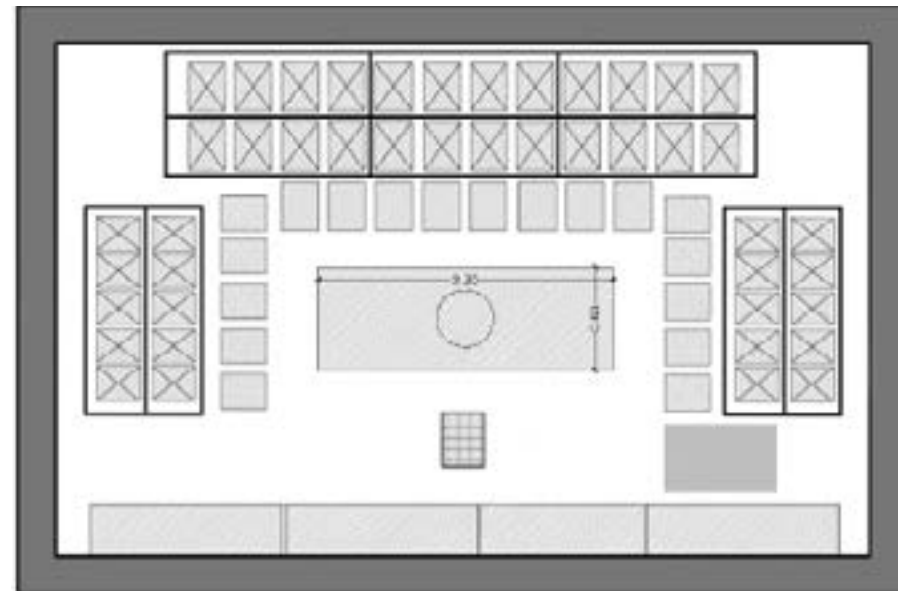

# LIGHTING PLAN / Conventional space

We serve any "general light" design for public. For example:

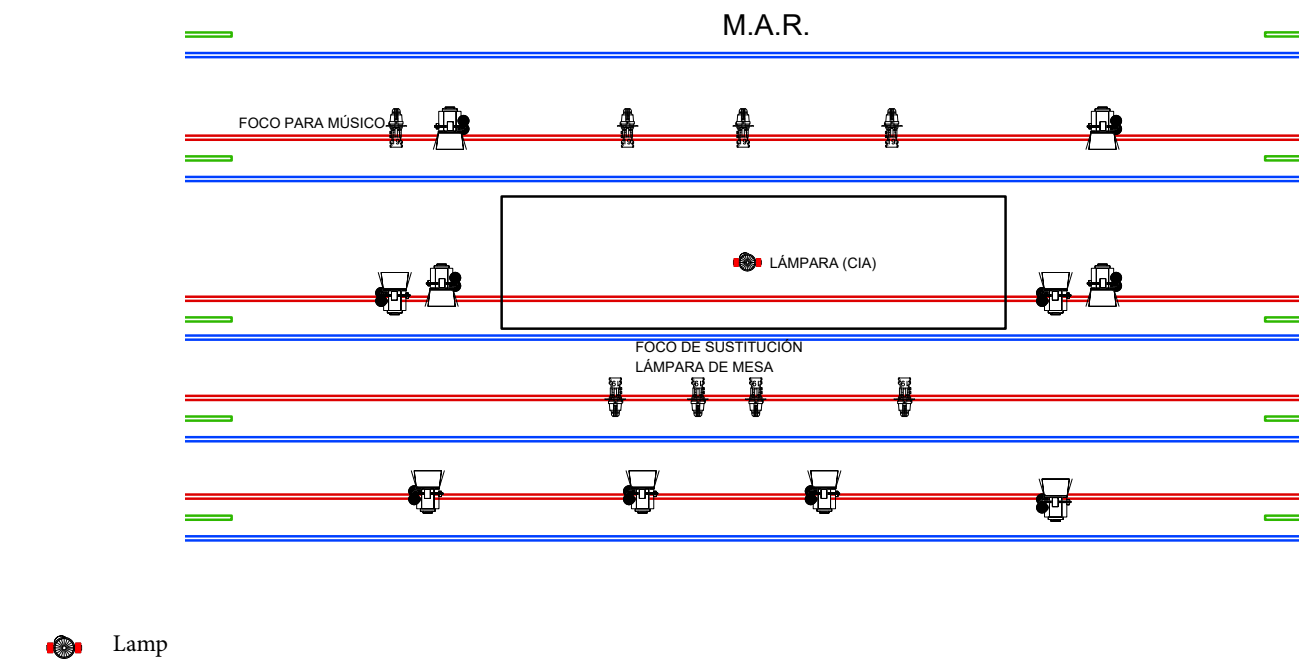

# TECHNICAL CONTACT

Andrea Díaz Reboredo  
andy\_diaz@hotmail.com  
+34 699 59 2931  
andreadiazreboredo.com

# DISTRIBUTION

Ana Sala – IKEBANAH ARTES ESCÉNICAS  
Anasala@ikebanah.es  
+34 619951791  
www.ikebanah.es/mar.php

